



LABELS ARE NOT EASILY ADJUSTED SO BE SURE TO APPLY THEM CORRECTLY USING THESE SIMPLE STEPS

STEP-BY-STEP INSTRUCTIONS:

Start by cleaning the surface so that it is free of any dust or dirt. Slowly peel the top portion of the backing away from the label (FIG 1)



FIG 1

Line up the top of the label where you want to apply it and slowly glide your hands back and fourth down the label (FIG 2)



FIG 2

Slowly peel off the rest of the backing, apply pressure and remove any air bubbles or imperfections as you glide along (FIG 3)

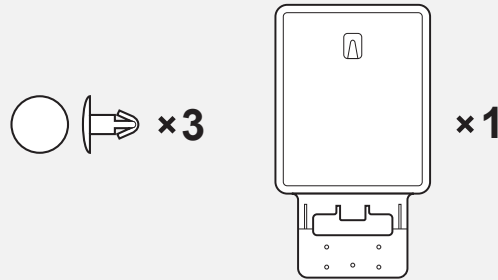

FIG 3

Best selection, lowest prices.

Call us for Quantity Discounts and Custom Designs!

800.664.5340 www.recycleaway.com



SIGNFRAME KIT CONTAINS:
1 SIGNFRAME WITH 3 SECURING CLIPS

STEP-BY-STEP INSTRUCTIONS:

- Tip the signframe and insert the two hooks under rim, on short end of bin.
- Push sign up into position.
- Support tab will slide over handle edge and rest in the handle.
- Mark holes (FIG 1) [or align holes if pre-drilled].
- Remove signframe and drill holes with $1\frac{1}{64}$ drill bit (FIG 2) [if not already pre-drilled].
- Repeat steps 1, 2, 3.
- Align the signframe and container hole by pushing signframe upward (FIG 3).
- Insert the securing clips with the heads inside the container.
- Slide 8.5x11" sign through top slot of signframe.



Best selection, lowest prices.

Call us for Quantity Discounts and Custom Designs!

800.664.5340 www.recycleaway.com

COMPONENTS:

- 2 Connector Clips
- 4 Plugs



PLEASE NOTE:

One connector kit connects two bins to each other.
For large stations, additional connector kits will be required.



Tip Facing
Inward

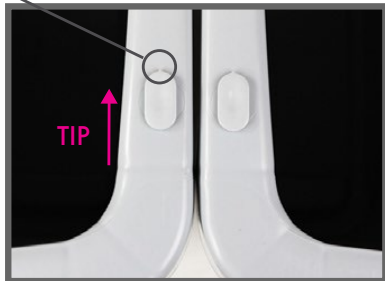

- 1 Line up containers to be connected.
Be sure to line up the pre-drill markings side-by-side as this is where sign frames will be installed if applicable. Even if no sign frames are being installed, it is recommended to line all bins up the same way for consistency.
- 2 Insert plugs with **pointed tip facing towards the center of the bin** as shown. Front plugs face back and back plugs will face forward. This is VERY IMPORTANT as if the plug is not set in the right position it will not securely fit and lock with the Connector Clip.

Best selection, lowest prices.

Call us for Quantity Discounts and Custom Designs!

800.664.5340 www.recycleaway.com



FIG. 1



FIG. 2

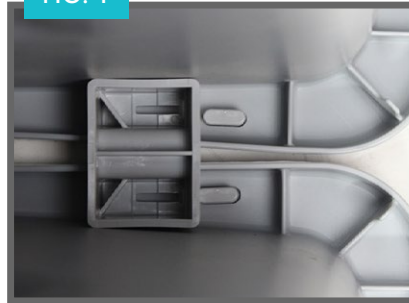

- 3 Place Connector Clip under rim past where plug ends are located. (FIG. 1)
Place each plug end into the slots in the Connector Clip and slide toward the outside of the container until it 'clicks' into place. (FIG. 2)
- 4 Repeat process for all connection locations.